

LEGO Studio 2.0 įdiegimo instrukcijos

Norint sėkmingai naudotis LEGO Studio 2.0 3D modeliavimo ir projektavimo programa, turite ją įsidiegti į kompiuterį.

- Nuoroda į programą: <https://www.bricklink.com/v3/studio/download.page>

FEEL THE DIFFERENCE

STUDIO 2.0

Download Studio 2.0 for Windows

requires Windows 7 SP1+ or higher

alternate versions: 32bit 64bit OS X

Build, render, and create instructions.
Do it all in Studio 2.0

Atsidarius nuorodai spustelkite čia ir Studio 2.0 programa atsisiųs į jūsų kompiuterį. Jei naudojate ne Windows operacinę sistemą, galite pasirinkti kitą alternatyvią versiją.

- Įdiegimas. Savo kompiuteryje suraskite atsiųstą Studio 2.0 failą ir paspauskite ant jo. Toliau sekite pateiktus žingsnius:

Setup - Studio 2.0 version 2.0

License Agreement

Please read the following important information before continuing.

Please read the following License Agreement. You must accept the terms of this agreement before continuing with the installation.

SOFTWARE LICENSE AGREEMENT

THIS SOFTWARE LICENSE AGREEMENT IS A LEGAL AGREEMENT BETWEEN LEGO BrickLink, Inc. ("BRICKLINK") AND YOU, THE LICENSEE. PLEASE READ THIS AGREEMENT CAREFULLY BEFORE DOWNLOADING AND INSTALLING OR USING STUDIO SOFTWARE ("STUDIO"). By DOWNLOADING, INSTALLING OR USING STUDIO, YOU ACKNOWLEDGE THAT YOU HAVE READ THIS AGREEMENT, UNDERSTAND IT, AND AGREE WITH ALL OF ITS TERMS AND CONDITIONS. IF YOU DO NOT AGREE WITH ALL TERMS AND CONDITIONS OF THIS AGREEMENT, DO NOT USE THE SOFTWARE.

I accept the agreement

I do not accept the agreement

Next > Cancel

Pasirinkite „I accept the agreement“ ir spustelkite „Next“

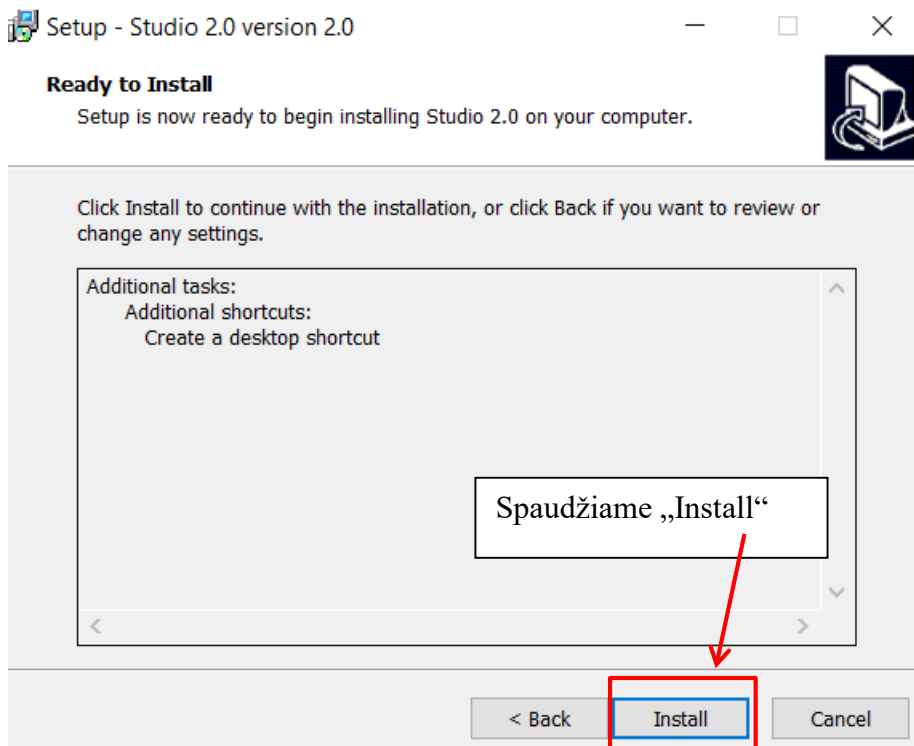
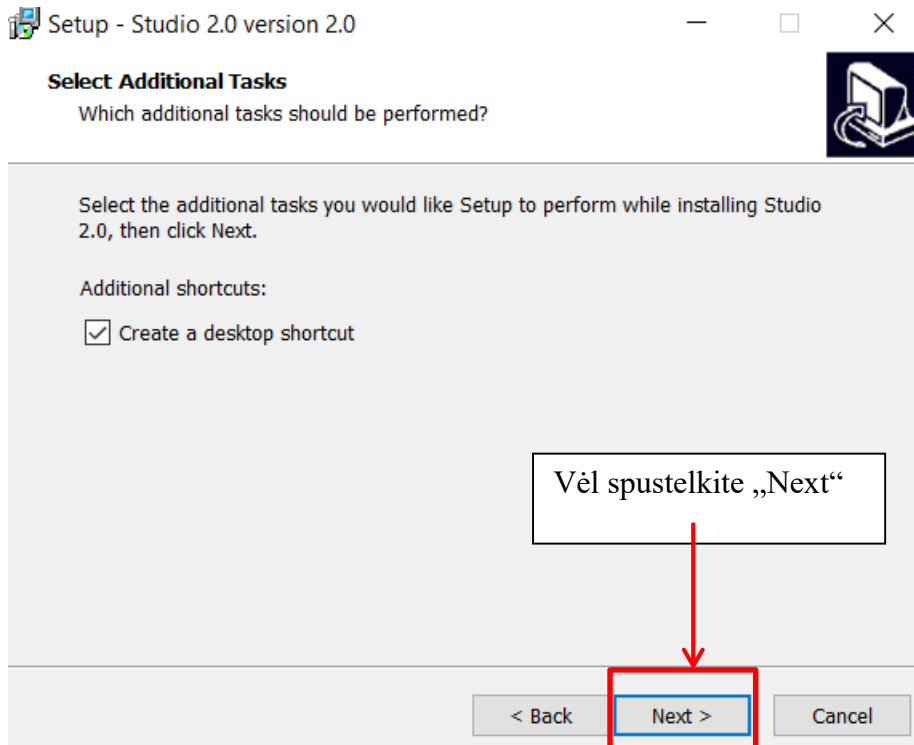

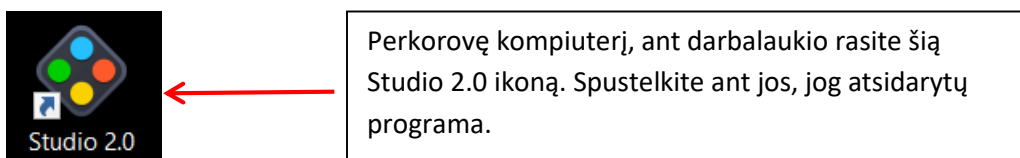
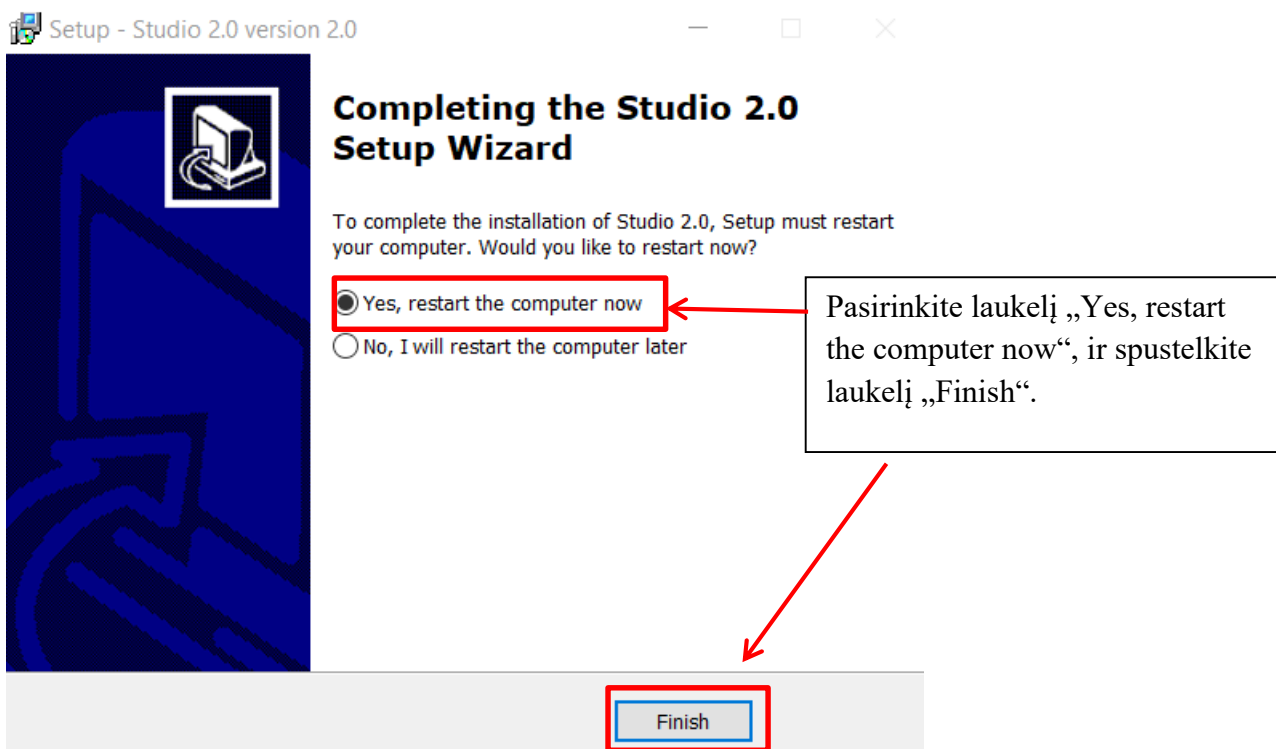
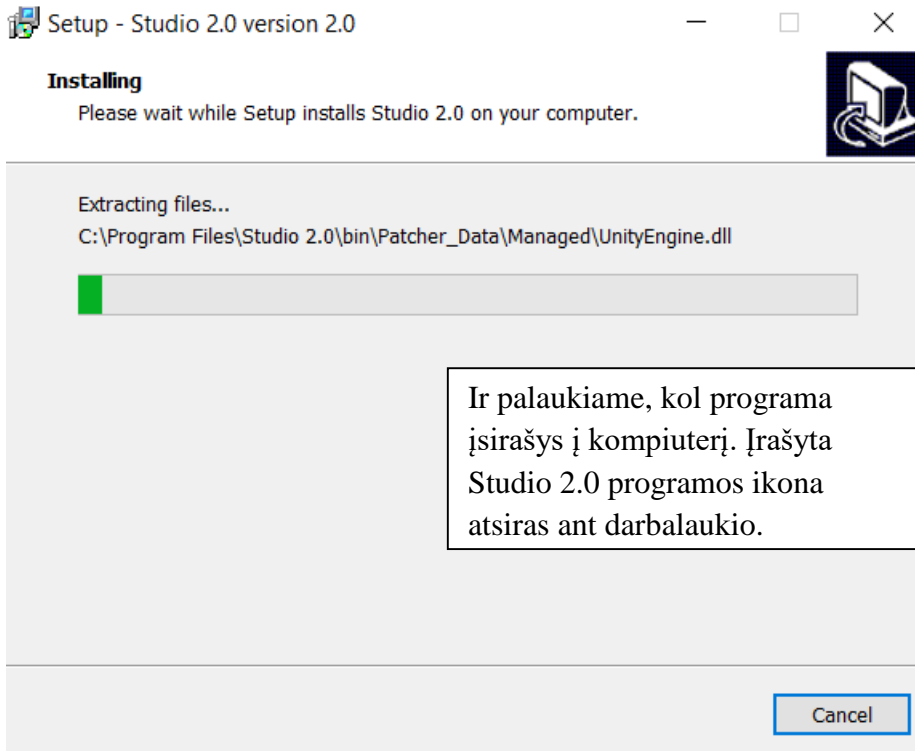

Atsidarę programą išvysite šį langą. Tai reiškia, jog sėkmingai įdiegėte programą į kompiuterį. Studio 2.0 yra paruošta darbui.

